



A Series Walkie Straddle Stacker

with capacities of 2,500lbs

The World of Hangcha
SINCE 1956



INDUSTRIAL STRENGTH STACKING

A series walkie straddle stacker is newly developed logistics handling equipment developed by Hangcha for the North American market. The AC drive control technology provides advanced performance, comfortable operation, safe and reliable, low maintenance costs. It can be use for loading and unloading in warehouses, supermarkets and workshops.



Appearance

- / A series walkie straddle stacker applied professional industrial design, stream lines, and compact, and fully ergonomic consideration, in line with the latest design trends.
- / Applied steel stamping and injection molding processes for front and back guard, which is robust, durable, and also environmental compliance.

Performance

- / AC travelling motor applied to provide excellent acceleration, good gradeability, low heat, no carbon brush and maintenance free.
- / The latest CURTIS AC control system provides accurate and stable control to work more efficient.
- / The applied CAN-BUS structure can offer more reliable and faster command access.
- / Regenerative brake and slope anti-slide function are offered by this truck.

Reliability

- / Water-proof plugs and connectors applied to provide a reliable protection to electric system.
- / Using non-contact proximity switch, it can provides long life and reliable operation.
- / Top quality hydraulic power unit applied to provide low noise, low vibration, smooth lifting and landing reliable operation.
- / Punch-formed forks to provide more strength and tip guide to provide higher efficient operation.
- / The power plug (Andersen) is fixed on the truck body to avoid damage from battery installment.

Comfort

- / Simple and beautiful tiller designed to operate all functions easily even by one hand.
- / Displayed turtle speed function applied to move slowly and helps to stack goods in narrow spaces.
- / Turtle speed function can keep the slow move when the tiller is vertical direction, the truck can stack goods even in narrow space.
- / Optimized design structure to offer a good visibility and easy entrance of the pallet.



Built-in charger and maintenance free battery



The compact body and big rounded design provide an ideal operation in limited space, and the wedge designed chassis greatly increases the passing ability



Pump motor controller offers proportional lowering, it can provide low noise, precise control and stable lower good



Fixed Straddle Baselegs (Inside Dimension in 4" increments from 38" to 50"); Adjustable baseleg optional to fit a wide range of pallet sizes



Standard features

- / 24 volt electrical system
- / CAN BUS communication
- / Curtis AC Controller
- / 7.8" Battery Compartment
- / PU drive tire
- / Maintenance-Free battery 150Ah
- / Built-in charger
- / SB-175 battery connector (red)
- / Battery disconnect handle
- / Key switch
- / Multi-function meter
- / Electric horn
- / Upright-tiller creep speed running
- / PU load wheel
- / Single load wheel
- / Load Backrest height 40"

Safety

- / Travel speed will be automatically reduced after fork lifting 500mm.
- / The power plug is fixed on the truck body to avoid damage from battery installment.
- / The applied slope anti-slip function ensures the safety of the operation.
- / The emergency button on the tiller head can effectively avoid the harm to the driver.
- / Soft landing system applied to offer protection to the loads from damaging.

Maintenance

- / AC motor with no cabin brush, don't need maintenance, lower cost.
- / Integrated battery indicator, hour meter and self-diagnostic instrument are all easy for maintenance.
- / Rear cover can be completely open, operator can see all the components, so the maintenance is very convenient.

Optional equipment

- / Maintenance-Free battery 225Ah
- / Industrial battery 240Ah
- / Load Backrest
- / PIN code access
- / Adjustable-width base legs
- / 2-Stage Mast 78-141in(2-3.6m)
- / Mast shield of PC plate





HANGCHA

A Series Walkie Straddle Stacker Specification

Distinguishing mark	1.1	Manufacturer		HANGCHA GROUP CO.,LTD.
		HCFA Model		WSS11M
	1.2	Manufacturer's type designation		CTD11-AC1-2NA
	1.4	Operator type: hand, pedestrian, standing, seated, order-picker		Walkie
	1.5	Rated capacity/rated load	Q (kg/lb)	1130/2500
	1.6	Load centre distance	c (mm/in)	600/24
	1.8	Load distance, centre of drive axle to fork	x (mm/in)	570/22
	1.9	Wheelbase	y (mm/in)	1240/49
	Weight	2.1	Service Weight Without Battery	kg/lb
Tyres, chassis	3.1	Tyres: solid rubber, superelastic, pneumatic, polyurethane		PU
	3.2	Tyre size, front	mm/in	Φ230×75/Φ9×3
	3.3	Tyre size, rear	mm/in	Φ100×70/Φ4×2.75
	3.4	Additional wheel (dimensions)	mm/in	/
	3.5	Wheels, number front / rear (x = driven wheels)		1x+2
	3.6	Tread, front	b ₁₀ (mm/in)	/
	3.7	Tread, rear	b ₁₁ (mm/in)	1170/46
Dimensions	4.2	Height, mast lowered	h ₁ (mm/in)	2050/81
	4.4	Lift	h ₂ (mm/in)	3000/118
	4.5	Height, mast extended	h ₄ (mm/in)	3550/140
	4.10	Height of wheel arms	h ₈ (mm/in)	100/4
	4.15	Fork height, lowered	h ₁₃ (mm/in)	35/1.4
	4.19	Overall length	l (mm/in)	1938/76
	4.20	Length to face of forks	l ₂ (mm/in)	867/34
	4.21	Overall width	b ₁ /b ₂ (mm/in)	710/1270(28/50)
	4.22	Fork dimensions	s/e/l (mm/in)	35/100/1070(1.4/3.9/42)
	4.25	Distance between fork-arms	b ₅ (mm/in)	210-790(8.3-31.1)
	4.26	Distance between wheel arms	b ₄ (mm/in)	1070/42
	4.32	Ground clearance, centre of wheelbase	m ₂ (mm/in)	40/1.57
	4.35	Turning radius	W _a (mm/in)	1437/56.6
4.37	Length across wheel arms	l ₇ (mm/in)	1546/61	
Performance data	5.1	Travel speed, laden/unladen	kph(mph)	6/6(3.7/3.7)
	5.2	Lift speed, laden/unladen	m/s(ft/min)	0.115/0.185(23/36)
	5.3	Lowering speed, laden/unladen	m/s(ft/min)	0.2/0.2(39/39)
	5.8	Max Gradeability, laden/unladen	%	10/16
Electric-engine	6.1	Drive motor rating S2 60 min	kW/hp	1.3/1.74
	6.2	Lift motor rating at S3 5%	kW/hp	2.2/2.95
	6.4	Battery voltage, rated capacity	V/Ah	24/150
8.1	Type of drive control			AC
9.1	Manufacturer			CURTIS

Mast

Mast type	Max. lifting height h ₂		Ground clearance, fork (h ₂ +h ₈)		Lowered height h ₁		Extended height h ₄ without load backrest		Free lift		Load capacity at 600mm	
	mm	in	mm	in	mm	in	mm	in	mm	in	kg	lb
Single cylinder Duplex mast	2000	78	2035	80	1550	61	2550	100	135	5.3	1135	2500
	2500	98	2535	100	1800	71	3050	120	135	5.3	1135	2500
	2700	106	2735	108	1900	75	3250	128	135	5.3	1135	2500
	3000	118	3035	119	2050	81	3550	140	135	5.3	1000	2200
	3300	130	3335	131	2200	87	3850	152	135	5.3	907	2000
	3500	137	3535	139	2385	94	4135	163	135	5.3	816	1800
	3600	141	3635	143	2435	96	4235	167	135	5.3	725	1600
Single cylinder Full-free mast	2500	98	2535	100	1800	71	3050	120	724	28.5	1135	2500
	2700	106	2735	108	1900	75	3250	128	824	32.4	1135	2500
	3000	118	3035	119	2050	81	3550	140	974	38.3	1000	2200
	3300	130	3335	131	2200	87	3850	152	1124	44.2	907	2000
	3500	137	3535	139	2385	94	4135	163	1309	51.5	816	1800
	3600	141	3635	143	2435	96	4235	167	1359	53.5	725	1600
Single-stage mast	1350	53	1385	54.5	1900	75	1915	75.4	825	32.5	1135	2500
	1500	59	1535	60.4	2050	81	2065	81.3	975	38.4	1135	2500
	1750	69	1785	70.2	2385	94	2400	94.5	1310	51.8	1135	2500

Aisle Guide

Aisle requirement-right angle stack ①

Load width		Load length					
		in(mm)	36(914)	40(1016)	42(1067)	44(1117)	48(1219)
30(762)	in(mm)	79.7(2024)	79.7(2024)	81.2(2063)	82.8(2103)	86.2(2189)	86.2(2189)
32(813)	in(mm)	79.7(2024)	79.7(2024)	80.4(2041)	81.9(2080)	83.4(2119)	86.8(2204)
36(914)	in(mm)	79.7(2024)	79.7(2024)	81.7(2075)	83.1(2112)	84.6(2149)	87.8(2230)
40(1016)	in(mm)	81.7(2074)	81.7(2074)	83.1(2112)	84.5(2147)	85.9(2183)	89.0(2261)
42(1067)	in(mm)	81.7(2074)	81.7(2074)	83.9(2132)	85.3(2166)	86.6(2200)	89.6(2276)
44(1117)	in(mm)	83.6(2123)	83.6(2123)	84.7(2151)	86.0(2184)	87.3(2218)	90.3(2293)
48(1219)	in(mm)	85.6(2173)	85.6(2173)	86.3(2192)	87.5(2223)	88.8(2255)	91.6(2327)

① Add a minimum of 12in (300mm) for maneuverability.

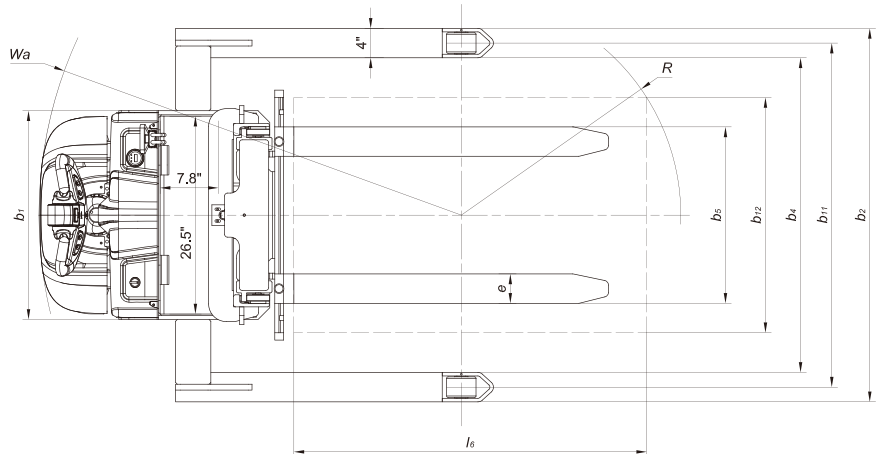
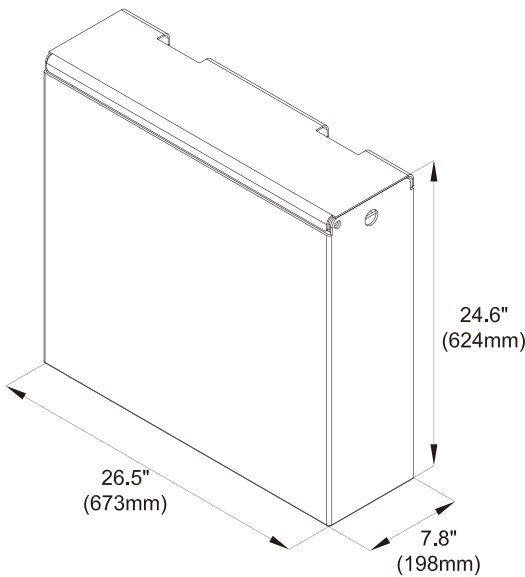
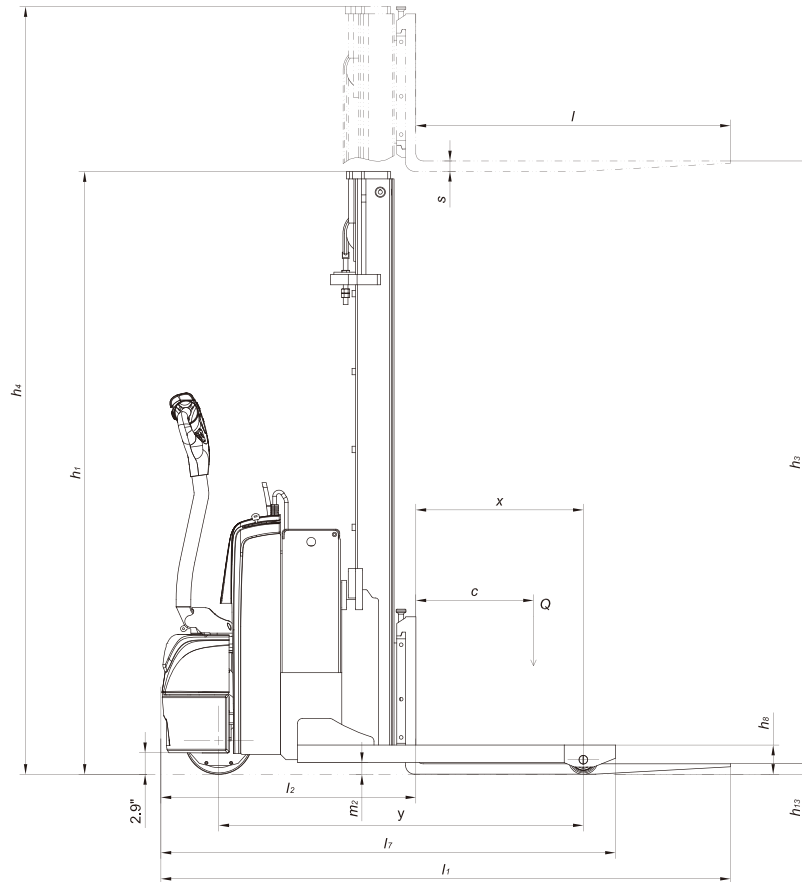



HANGCHA AMERICA CORPORATION

Company address:

10405-A Granite Street Charlotte,
NC 28273

Toll Free: 888-652-8395

Phone: 980-888-8335

Fax: 980-888-8336

america@hcforklift.com

www.hcforkliftamerica.com



ISO14001:2015



ISO9001:2015



Follow us on
Facebook



Follow us on
YouTube



Follow us on
WeChat



Download "Hangcha
Forklift" App

HANGCHA GROUP CO., LTD. reserves the right to make any changes without notice concerning colors, equipment, or specifications detailed in this brochure, or to discontinue individual models. The colors of trucks, delivered may differ slightly from those in brochures.